

Fairfield Village at Quincy Reservoir - General Development Plan

CITY OF AURORA, COLORADO

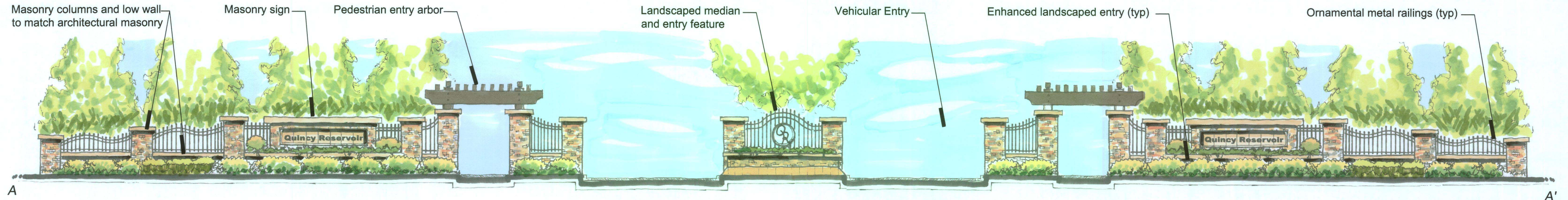

Entry monumentation concept

Elevation A - Entry off Reservoir Road

Scale: 1' = 3/16"

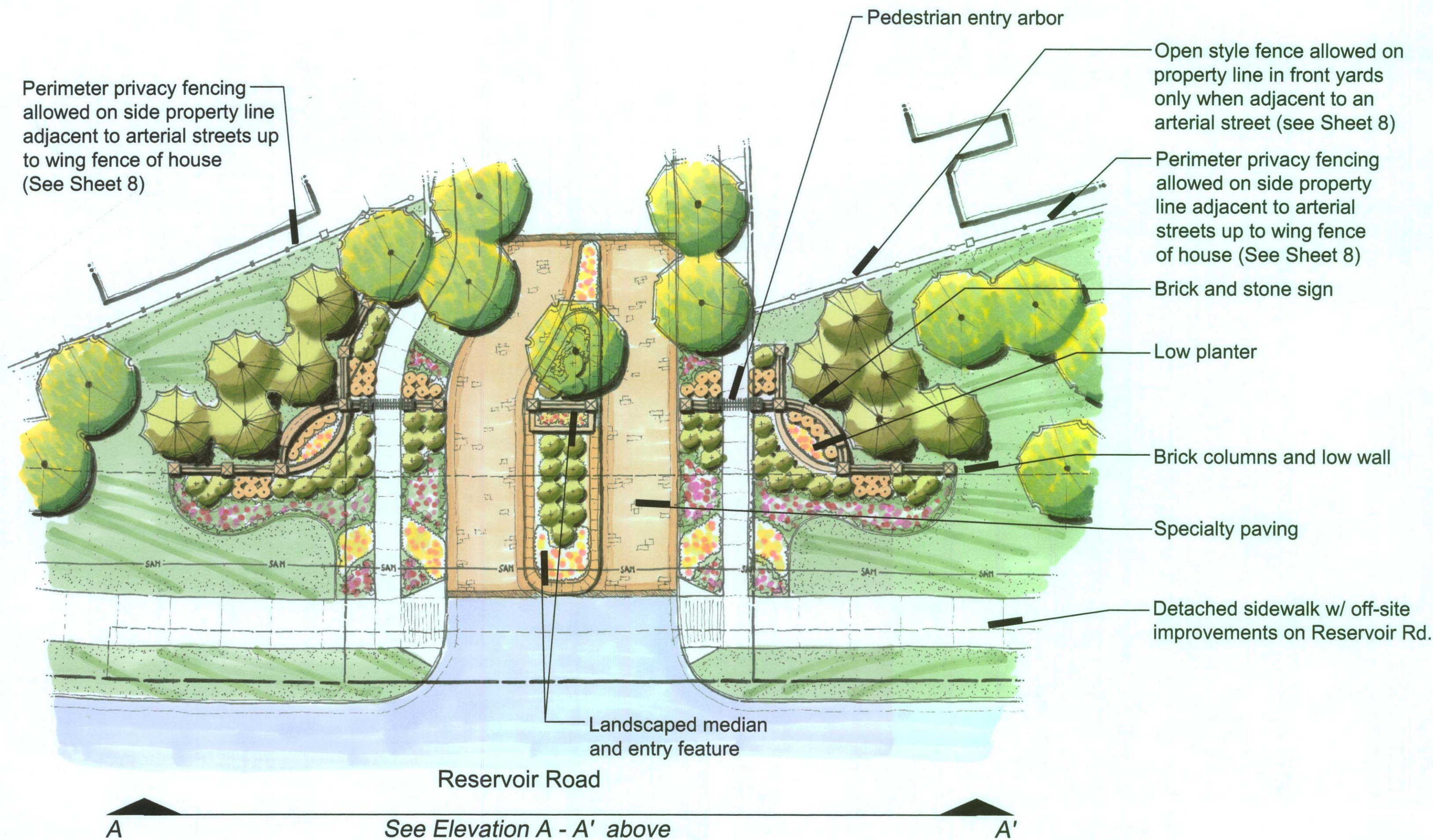

Primary Entry Concept Plan

Plan - Entry off Reservoir Road

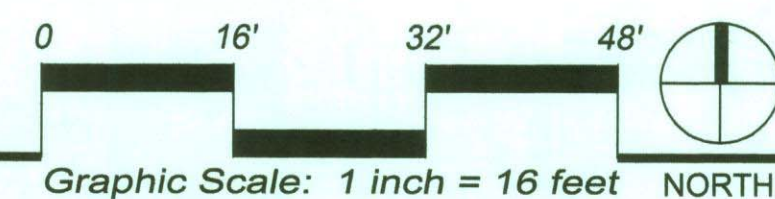

Secondary Entry Monumentation Concept

Elevation B - Entry through Commercial Use Area A

Scale: 1' = 3/16"

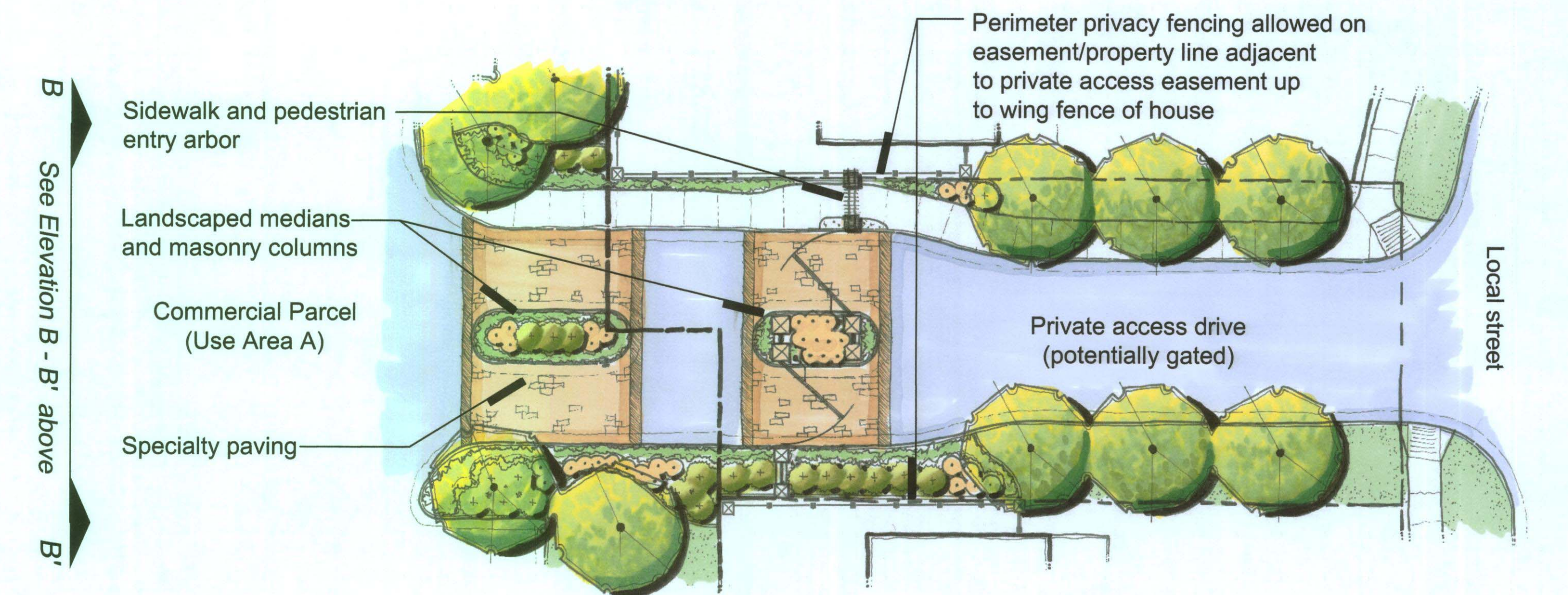

Secondary Entry Concept Plan

Connection between Commercial and Residential Areas

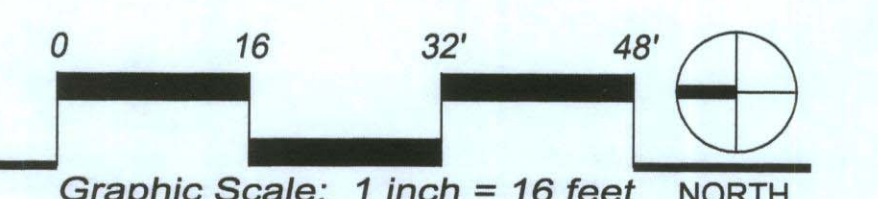

Illustrative Elevations & Design Elements

Graphics shown are conceptual only to show general design intent and character of design elements, relationships between areas, etc. and may change slightly with final design.

Drawn by: JLW Submitted: JANUARY 10, 2005
 Checked by: MC Revised:
 Job No: 04010

LAND ARCHITECTS
 9137 S Ridgeline Blvd, ste 130 • Highlands Ranch, Colorado • Ph (303) 734-1777 • Fax (303) 734-1778